

FRANKLIN CORRECTIONAL FACILITY DOOR REPLACEMENT

62 BARE HILL ROAD
TOWN OF MALONE

FRANKLIN COUNTY, STATE OF NEW YORK

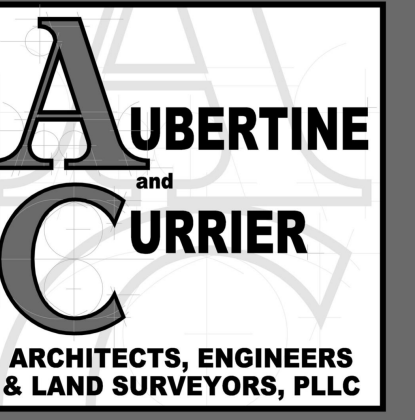

NYS WBE/DBE Certified
SBA Woman Owned
Small Business (WOSB)

aubertinecurrier.com

522 Bradley Street
Watertown, New York 13601
Phone: (315)782-2005

The above Architect, Engineer or Land Surveyor states that to the best of his or her knowledge, information and belief, the plans and specifications are in accordance with applicable requirements of New York State. It is a violation of New York State Law for any person, unless acting under the direct supervision of a Registered Architect, Licensed Professional Engineer or Licensed Land Surveyor to alter this document in any way. If altered, such licensee shall affix his or her seal and the notification "altered by" followed by his or signature, date and a specific description of the alteration.

© COPYRIGHT 2024
AUBERTINE and CURRIER ARCHITECTS, ENGINEERS & LAND SURVEYORS, PLLC

INDEX OF DRAWINGS

- G001 COVER SHEET
- G100 GENERAL NOTES AND SPECIFICATIONS
- A100 NEW WORK PLAN & DEMOLITION PLAN
- A101 SECTION & DETAILS

PROJECT LOCATION

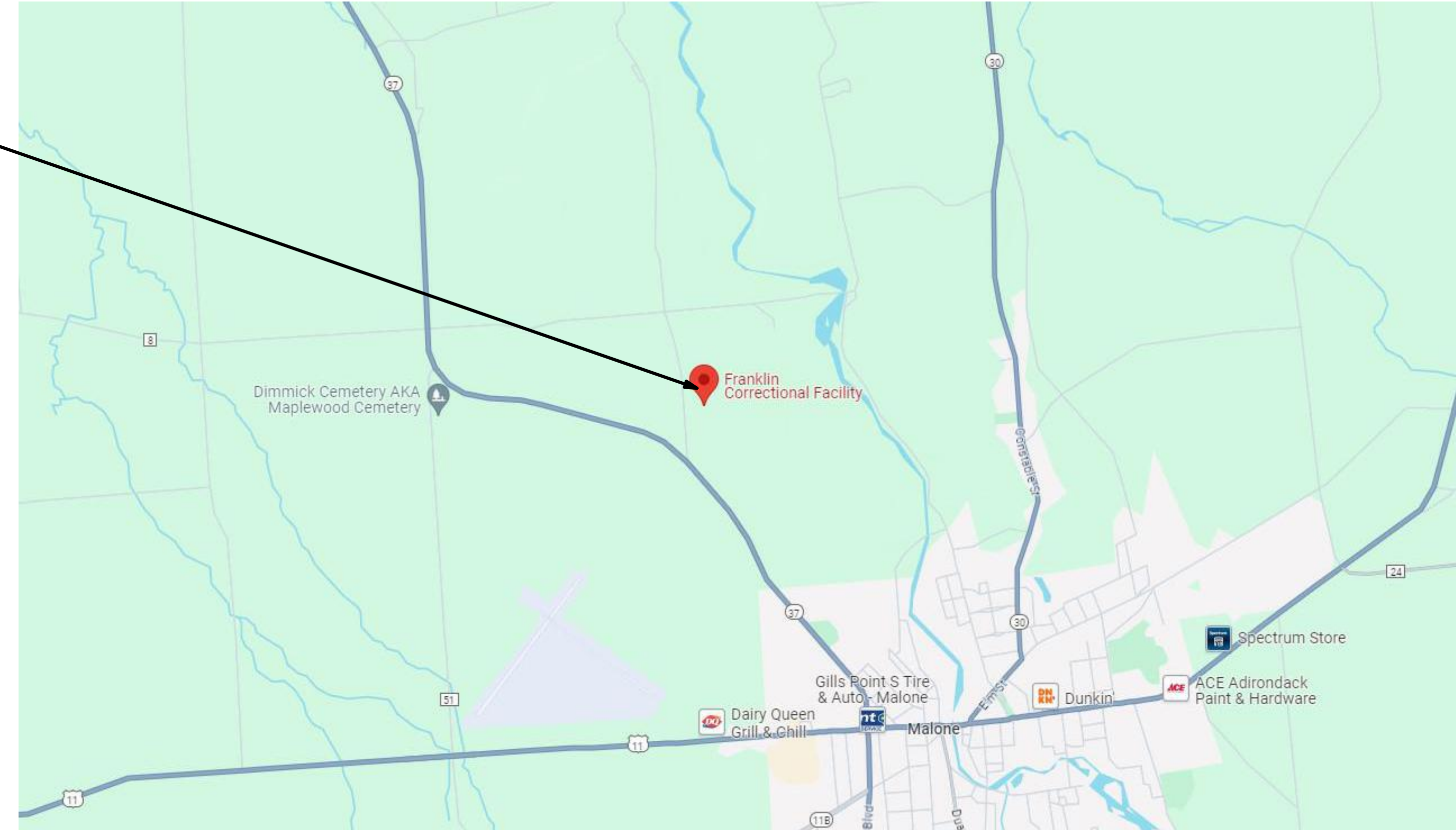

SITE LOCATION MAP

NEW YORK STATE DEPT. OF CORRECTIONS
 FRANKLIN CORRECTIONAL FACILITY
 62 BARE HILL RD.
 TOWN OF MALONE
 FRANKLIN COUNTY, STATE OF NEW YORK

PROJECT NO:	2023-162
SCALE:	
DRAWN BY:	EMW / BMK
CHECKED BY:	BMK
ISSUE DATES:	
DATE	05-21-2024 - BID SET

COVER SHEET

SECURE FACILITY
DON'T SHARE TO PUBLIC

G001

PROGRESS PRINT - NOT FOR CONSTRUCTION

GENERAL NOTES

- THIS PROJECT HAS BEEN DESIGNED BY THE OFFICE OF ALBERTINE AND CURRIER ARCHITECTS, ENGINEERS & LAND SURVEYORS, PLLC IN ACCORDANCE WITH THE LATEST (2020) NEW YORK STATE BUILDING CODE, (2020) NEW YORK STATE FIRE CODE, (2020) NEW YORK STATE MECHANICAL CODE, (2020) NEW YORK STATE PLUMBING CODE, (2020) NEW YORK STATE FUEL GAS CODE, (20) NEW YORK STATE ENERGY CODE. TO THE BEST OF OUR KNOWLEDGE AND BELIEF THE CONSTRUCTION DOCUMENTS ARE IN CONFORMANCE THEREWITH. THE CONTRACTOR IS RESPONSIBLE FOR ADHERING TO ALL MEANS AND METHODS OF THE BUILDING CODE AND ALL REFERENCED STANDARDS FOR CONSTRUCTION.
- THESE DRAWINGS ARE IN PART DIAGRAMMATIC. THE DRAWINGS ARE INTENDED TO CONVEY THE GENERAL INTENT OF THE PROJECT IN ORDER TO BID THE PROJECT OUT TO CONTRACTORS AND OBTAIN BUILDING PERMIT.
- THE CONTRACTOR SHALL INSTALL ALL MATERIALS, PRODUCTS AND EQUIPMENT IN ACCORDANCE WITH MANUFACTURERS SPECIFICATIONS AND IN SATISFACTION OF THE GOVERNING BUILDING CODE STANDARDS FOR PERFORMANCE OF WORK.
- THE CONTRACTOR SHALL BE RESPONSIBLE FOR SAFETY PRECAUTIONS AND PROGRAMS IN CONNECTION WITH THE WORK. THE CONTRACTOR SHALL INDEMNIFY THE OWNER AND HIS AGENTS THROUGH ADEQUATE INSURANCE COVERAGE AGAINST ANY CLAIMS ARISING FROM CONSTRUCTION RELATED INJURIES OR FAILURE TO MAINTAIN SAFE WORK CONDITIONS ON SITE.
- THE CONTRACTOR & OWNER SHALL REVIEW AND BECOME FAMILIAR WITH ALL DRAWINGS PRIOR TO COMMENCEMENT OF WORK. ANY INCONSISTENCIES FOUND BETWEEN THE DRAWINGS SHALL BE REPORTED TO THE ARCHITECT BY THE CONTRACTORS. DO NOT PERFORM ANY WORK AFFECTED IN ANY MANNER BY THE INCONSISTENCIES UNTIL THE ARCHITECT HAS CLARIFIED THE INFORMATION.
- THE CONTRACTOR SHALL MAINTAIN CLEAN AND SAFE WORKING CONDITIONS ON SITE.
- THE CONTRACTOR SHALL FIELD VERIFY ALL EXISTING CONDITIONS INCLUDING BUT NOT LIMITED TO DIMENSIONS, ELEVATIONS, AND MATERIALS PRIOR TO COMMENCEMENT OF WORK. NOTIFY THE ARCHITECT IMMEDIATELY WITH ANY DISCREPANCIES PRIOR TO PROCEEDING WITH THE WORK. THE CONTRACTOR SHALL ESTABLISH AND MAINTAIN ACCURATE BENCHMARKS FOR LAYOUT OF ALL WORK.
- ALL DIMENSIONS ARE TO THE FACE OF THE STUD AND TO CENTERLINE OF COLUMNS UNLESS NOTED OTHERWISE. WHERE INSULATED CONCRETE FORMS (ICF) ARE USED, DIMENSIONS TO THE FORMS SHALL BE TO THE FACE OF FORM. DRAWINGS AT LARGER SCALE TAKE PRECEDENCE OVER DRAWINGS AT SMALLER SCALE. DO NOT SCALE THE DRAWINGS. THE ARCHITECT SHALL PROVIDE ADDITIONAL DIMENSIONS IF NOT SHOWN ON THE DRAWINGS.
- DIMENSIONS ON DRAWINGS AT LARGER SCALE TAKE PRECEDENCE OVER DRAWINGS AT SMALLER SCALE. DO NOT SCALE THE DRAWINGS. THE ARCHITECT SHALL PROVIDE ADDITIONAL DIMENSIONS IF NOT SHOWN ON THE DRAWINGS.
- ALL MASONRY DIMENSIONS, INDICATED "M.O.", ARE NOMINAL DIMENSIONS, UNLESS OTHERWISE NOTED. ACTUAL MASONRY OPENING DIMENSION = NOMINAL MASONRY OPENING DIMENSION + ONE (1) MORTAR JOINT (I.E., 4'-0" M.O. = 4'-0" + 1/2" ACTUAL OPENING DIMENSION).
- REFER TO PLAN ENLARGEMENTS FOR ADDITIONAL DIMENSIONS.
- REFER TO DOOR AND WINDOW SCHEDULES AND REFERENCES FOR DETAILS. PROVIDE MINIMUM 4-INCH CLEARANCE FROM FACE OF DOOR JAMB TO FACE OF ADJACENT WALL, UNLESS OTHERWISE NOTED.
- WHERE EXISTING ACCESS PANELS CONFLICT WITH CONSTRUCTION, RELOCATE PANELS TO ALIGN WITH AND FIT WITHIN NEW CONSTRUCTION.
- ALL FURNITURE IS PLACEHOLDER FOR SPATIAL LAYOUT. FURNITURE SHALL BE PROVIDED BY OWNER UNLESS NOTED OTHERWISE IN DOCUMENTS.
- PROVIDE FIRE-TREATED WOOD BLOCKING OR MINIMUM 0.0312-INCH THICK STEEL FLAT STRAP AND BACKING PLATE AT, BUT NOT LIMITED TO, THE FOLLOWING LOCATIONS: TOILET ACCESSORIES, CASEWORK, MILLWORK, DOOR WALL BUMPERS, AND ALL OTHER WALL MOUNTED EQUIPMENT OR DEVICES.
- FLOOR PATCH AND FLOOR LEVELING: REPAIR EXISTING TOPPING SLAB AND CONCRETE FLOOR AT DEMOLITION OF WALLS AND AT ALL OTHER LOCATIONS AS REQUIRED. REFER TO DEMOLITION DRAWINGS FOR NOTES.
- THE CONTRACTOR SHALL OBTAIN ALL REQUIRED PERMITS AND INSPECTIONS.
- THE CONTRACTOR SHALL REQUEST THE LOCATION AND STAKING OF ALL BURIED UTILITIES PRIOR TO EXCAVATION. CONTACT LOCAL UFPO.
- THE CONTRACTOR SHALL NOTIFY THE ARCHITECT IF ANY SUBSTANDARD SOIL CONDITIONS ARE FOUND DURING EXCAVATION THAT WOULD AFFECT THE DESIGN OF THE FOOTINGS AND FOUNDATIONS.
- PATCHING TO MATCH EXISTING:**
 - PROTECT NON-DEMO AREA OF WORK AND ADJACENT AREAS FROM DAMAGE.
 - PROVIDE ALL OPENINGS REQUIRED FOR ALL TRADES AND PATCH TO MATCH EXISTING. AT EXISTING CONSTRUCTION ALTERED OR DISTURBED BY THE INSTALLATION, RELOCATION, OR REMOVAL OF HEATING, VENTILATING, AIR CONDITIONING, PLUMBING AND/OR ELECTRICAL EQUIPMENT AND DEVICES.
 - PATCH TO MATCH EXISTING (PTME). ALL AREAS ADJACENT TO, OR DISTURBED BY, NEW CONSTRUCTION OR EXISTING CONSTRUCTION TO BE REMOVED. PATCH TO MATCH INCLUDES FINISH MATERIAL (PAINT OR WVC OR CERAMIC TILE, ETC.) TO MATCH EXISTING.
 - PATCH ALL DEFECTS IN, AND FINISH TO MATCH EXISTING. ALL AREAS WHICH ARE TO RECEIVE NEW MATERIALS, FINISHES AND ITEMS CALLED FOR IN THE CONTRACT DOCUMENTS. PREPARE ALL EXISTING SURFACES TO RECEIVE NEW FINISHES AS REQUIRED.
- THESE DRAWINGS ARE CONFIDENTIAL TO THE PUBLIC AND SHOULD BE USED FOR THE BIDDING & CONSTRUCTION OF THE PROJECT.
- CONTRACTOR SHALL COORDINATE ACCESS TO THE WORK WITH FRANKLIN CORRECTIONAL FACILITY AND THE DEPARTMENT OF CORRECTIONS. ALL TOOLS SHALL BE INVENTORIED AND INSPECTED PRIOR TO ACCESS TO THE SITE.

GRAPHIC SYMBOLS LEGEND

ROOM DESIGNATION	KITCHEN → ROOM NAME 100 → ROOM NUMBER
NEW WALL	
EXISTING WALL TO REMAIN	
EXISTING WALL TO DEMOLISH	
PARTITION DESIGNATION	
WINDOW DESIGNATION	EMERGENCY EGRESS WINDOW DESIGNATION
DOOR DESIGNATION	ROOM NUMBER DOOR LETTER
KEYNOTE DESIGNATION	12
LEVEL DESIGNATION	TOP OF PLATE 110'-0"
INTERIOR ELEVATION	ELEVATION REFERENCE SHEET REFERENCE
WALL SECTION	SECTION REFERENCE SHEET REFERENCE
BUILDING SECTION	SECTION REFERENCE SHEET REFERENCE
REVISION DESIGNATION	1
COLUMN GRID LINE	AA
PLAN NORTH	
PLAN, ELEVATION OR SECTION TITLE	
SCALE	1/4" = 1'-0"
PLAN, ELEVATION OR SECTION DESIGNATION	1ST FLOOR PLAN
SMOKE DETECTOR	
CARBON MONOXIDE DETECTOR	
COMBO CARBON MONOXIDE / SMOKE DETECTOR	
ROOF SLOPE INDICATOR	5/12

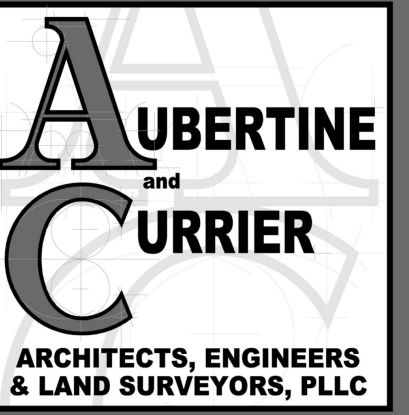

NYS WBE/DBE Certified
SBA Woman Owned
Small Business (WOSB)

aubertinecurrier.com

522 Bradley Street
Watertown, New York 13601
Phone: (315)782-2005

The above Architect, Engineer or Land Surveyor states that to the best of his or her knowledge, information and belief, the plans and specifications are in accordance with applicable requirements of New York State. It is a violation of New York State Law for any person, unless acting under the direct supervision of a Registered Architect, Licensed Professional Engineer or Licensed Land Surveyor to alter this document in any way. If altered, such licensee shall affix his or her seal and the notification "altered by" followed by his or signature, date and a specific description of the alteration.
© COPYRIGHT 2024
ALBERTINE AND CURRIER ARCHITECTS, ENGINEERS & LAND SURVEYORS, PLLC

NEW YORK STATE DEPT. OF CORRECTIONS
FRANKLIN CORRECTIONAL FACILITY
62 BARE HILL RD.
TOWN OF MALONE
FRANKLIN COUNTY, STATE OF NEW YORK

PROJECT NO: 2023-162

SCALE: As indicated

DRAWN BY: EMW / BMK

CHECKED BY: BMK

ISSUE DATES:

DATE: 06-21-2024 - BID SET

GENERAL NOTES AND SPECIFICATIONS

SECURE FACILITY
DON'T SHARE TO PUBLIC

G100

STRUCTURAL STEEL NOTES

- STRUCTURAL STEEL FRAMING IS DESIGNED WITH THE LATEST AISC MANUAL.
- ANY HANGERS SUPPORTING EQUIPMENT, DUCTWORK, PIPING, ETC. SHALL USE A CLIP TO ATTACH TO STRUCTURAL MEMBERS. DRILLING THROUGH STRUCTURAL MEMBERS SHALL NOT BE ALLOWED.
- STRUCTURAL STEEL GRADES (UNLESS NOTED OTHERWISE):
 - STRUCTURAL STEEL (W, C): ASTM A572 (ASTM A992), Fy=50ksi
 - STRUCTURAL STEEL (L, PLATES): ASTM A36, Fy=36ksi
 - STRUCTURAL TUBING: ASTM A500, Fy=46ksi
 - STRUCTURAL STEEL PIPE: ASTM A53 GRADE B, Fy=35ksi
 - BOLTS: ASTM A325N, PRE-TENSIONED IN STD HOLES
 - ANCHOR RODS: F1554, GRADE 36
 - SHEAR CONNECTORS: ASTM A108
 - WELDS: E70xx
 - GALVANIZING:
 - STRUCTURAL STEEL: ASTM A123
 - BOLTS, FASTENERS, HARDWARE: ASTM A153
- WELDS NOT INDICATED FOR STEEL-TO-STEEL CONNECTIONS SHALL BE AN ALL AROUND FILLET WELD WITH A MINIMUM THROAT THICKNESS PER AISC AND AWS STANDARDS.
- ALL STRUCTURAL STEEL SHALL BE COATED AS INDICATED BELOW. APPLY COATINGS IN ACCORDANCE WITH MANUFACTURERS RECOMMENDATIONS, INCLUDING SURFACE PREPARATIONS AND COMPATIBILITY REQUIREMENTS BETWEEN ALL COATINGS. AFTER ERECTION TOUCH UP ALL AREAS WHERE PAINT OR GALVANIZING IS MISSING OR DAMAGED INCLUDING FIELD WELDS. COLOR SHALL BE AS DETERMINED BY THE OWNER OR ARCHITECT.
 - EXTERIOR EXPOSED STEEL
 - ALL OTHER STRUCTURAL STEEL SHALL BE SHOP PAINTED WITH A MODIFIED ALKYD RUST INHIBITIVE PRIMER, 2.5 TO 3.5 MILS DFT (BASIS OF DESIGN IS TMEC SERIES 10).
 - EXTERIOR EXPOSED STEEL (WHERE INDICATED) TO BE PRIMED & PAINTED WITH THE THREE-COAT SYSTEM AS FOLLOWS (BASIS OF DESIGN IS TMEC):
 - SURFACE PREP: -SSPC-6, 'COMMERCIAL BLAST CLEANING' SSSPC-11, 'POWER TOOL CLEANING TO BARE METAL' FOR FIELD WELDS
 - PRIMER: MOISTURE CURED URETHANE ZINC RICH PRIMER, 2.5 TO 3.5 MILS DFT
 - INTERMEDIATE COAT: POLYAMIDAMINE EPOXY, 2.0 TO 3.0 MILS DFT
 - FINISH COAT: ALIPHATIC ACRYLIC POLYURETHANE, 2.0 TO 3.0 MILS DFT
- BEAM CONNECTIONS SHALL BE DESIGNED FOR THE LARGEST OF THE FOLLOWING: END REACTIONS COMPUTED FROM THE TABLE 'UNIFORM LOAD CONSTANTS' IN THE AISC MANUAL, THE REACTIONS SHOWN ON THE PLANS, OR A SERVICE LOAD OF 10K. ALL OTHER CONNECTIONS SHALL BE DESIGNED TO TRANSFER THE FULL DESIGN STRENGTH OF THE MEMBERS IN QUESTION, UNLESS SPECIFICALLY DETAILED OTHERWISE.
- ALL CONNECTIONS AND DETAILS NOT SPECIFICALLY INDICATED ON THE DRAWINGS ARE SUBJECT TO REVIEW AND APPROVAL BY THE ARCHITECT AND ENGINEER.
- UNLESS NOTED OTHERWISE, PROVIDE A 1/4" BENT PLATE AT THE PERIMETER OF ALL ROOF AND FLOOR EDGES AND OPENINGS.
- UNLESS INDICATED OTHERWISE, PROVIDE A 1/4" CAP PLATE AT THE ENDS OF HSS AND PIPE MEMBERS, IF VENT HOLES ARE USED FOR GALVANIZING, SEAL THE HOLES AFTER GALVANIZING.
- SUBMIT SHOP DRAWINGS FOR STRUCTURAL STEEL FOR REVIEW PRIOR TO CONSTRUCTION.

DEMOLITION NOTES

- REMOVE EXISTING OVERHEAD COILING DOOR IN ITS ENTIRETY. ALL DOOR COMPONENTS INCLUDING GUIDES, HOIST CHAINS, AND JAMBS SHALL BE REMOVED AND DISPOSED OF PROPERLY OFFSITE.
- REMOVE EXISTING BOLLARD IN ITS ENTIRETY INCLUDING FOUNDATIONS AND DISPOSE OF PROPERLY OFFSITE.
- REMOVE EXISTING STEEL WIRE GATE IN ITS ENTIRETY AND DISPOSE OF PROPERLY OFFSITE.
- WIDEN OPENING TO ACCOMMODATE 10'-0" WIDE CLEAR OPENING AT PREVIOUS DOOR LOCATION AS INDICATED IN DRAWINGS. COORDINATE WITH OVERHEAD DOOR SUPPLIER FOR ACTUAL OPENING DIMENSIONS.
- DASHED LINE INDICATES LIMITS OF DISTURBANCES. CONTRACTOR SHALL REMOVE EXISTING CONCRETE APRON TO THE EXTENTS INDICATED. CONTRACTOR SHALL VERIFY ALL EXISTING CONDITIONS BELOW GRADE AND CLARIFY WITH OWNER/ARCHITECT FOR ANY VARIATIONS.

NEW CONSTRUCTION NOTES

- PROVIDE NEW OVERHEAD COILING DOOR. BASIS OF DESIGN: OVERHEAD DOOR - ROLLING STEEL SERVICE DOOR R80. SIZE TO BE 10'11". FINISH TO BE PAINTED RED-TONE PAINTED TO MATCH EXISTING. DOOR OPERATION TO BE MANUAL CHAIN HOIST. PROVIDE WITH FULL WEATHER PROOF SEAL & OPERATOR ENCLOSURE.
- PROVIDE NEW BOLLARDS AS INDICATED IN DRAWINGS. PROVIDE NEW FOUNDATIONS AS INDICATED IN DETAILS. COORDINATE LOCATIONS WITH EXISTING SITE COMPONENTS AND DOOR OPENINGS.
- PROVIDE NEW SWING STYLE STEEL WIRE GATE AT NEW OPENING. SIZE OF GATE SHALL BE 10'X10'. FINISH SHALL BE GALVANIZED STEEL WITH PAINT FINISH BASIS OF DESIGN. WIRE CRAFTERS WITH (4) HEAVY DUTY HINGES PER LEAF & DEAD BOLT LOCKABLE CLASP AT MEETING STYLE.
- PROVIDE NEW REINFORCED CONCRETE SLAB ON GRADE. SEE DETAILS FOR NOTES.
- NEW W8X48 STEEL BEAM. PROVIDE 8' BEARING @ EACH SIDE OF OPENING. CONTRACTOR TO PROVIDE SHORING DESIGN BY LICENSED NYS P.E.

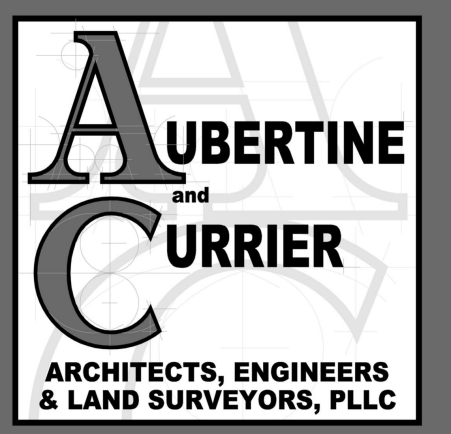

NYS WBE/DBE Certified
SBA Woman Owned
Small Business (WOSB)

aubertinecurrier.com

522 Bradley Street
Watertown, New York 13601
Phone: (315)782-2005

The above Architect, Engineer or Land Surveyor states that to the best of his or her knowledge, information and belief, the plans and specifications are in accordance with applicable requirements of New York State. It is a violation of New York State Law for any person, unless acting under the direct supervision of a Registered Architect, Licensed Professional Engineer or Licensed Land Surveyor to alter this document in any way. If altered, such licensee shall affix his or her seal and the notification "altered by" followed by his or her signature, date and a specific description of the alteration.
© COPYRIGHT 2024
AUBERTINE and CURRIER ARCHITECTS, ENGINEERS & LAND SURVEYORS, PLLC

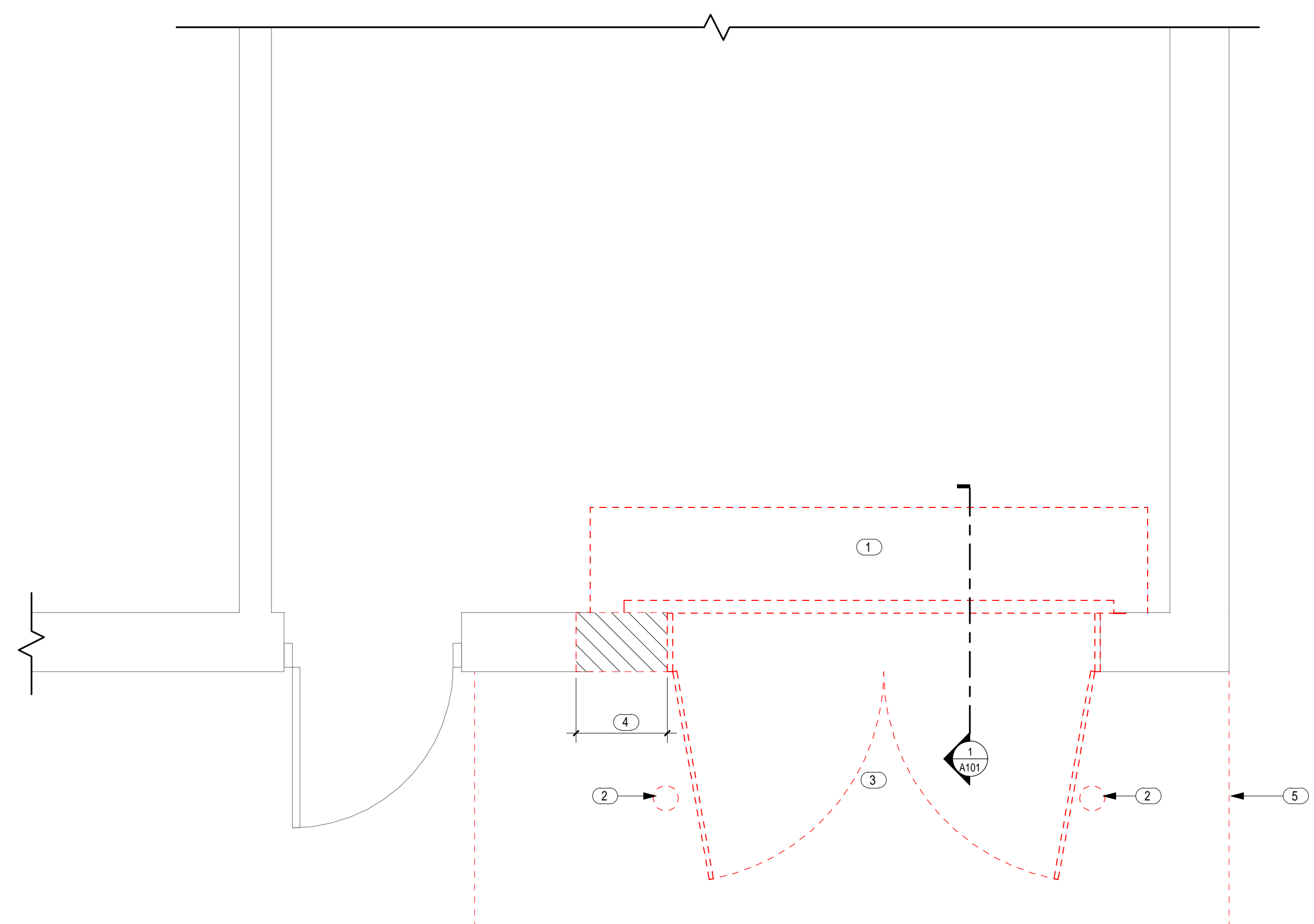

A DEMOLITION PLAN
1/2" = 1'-0"

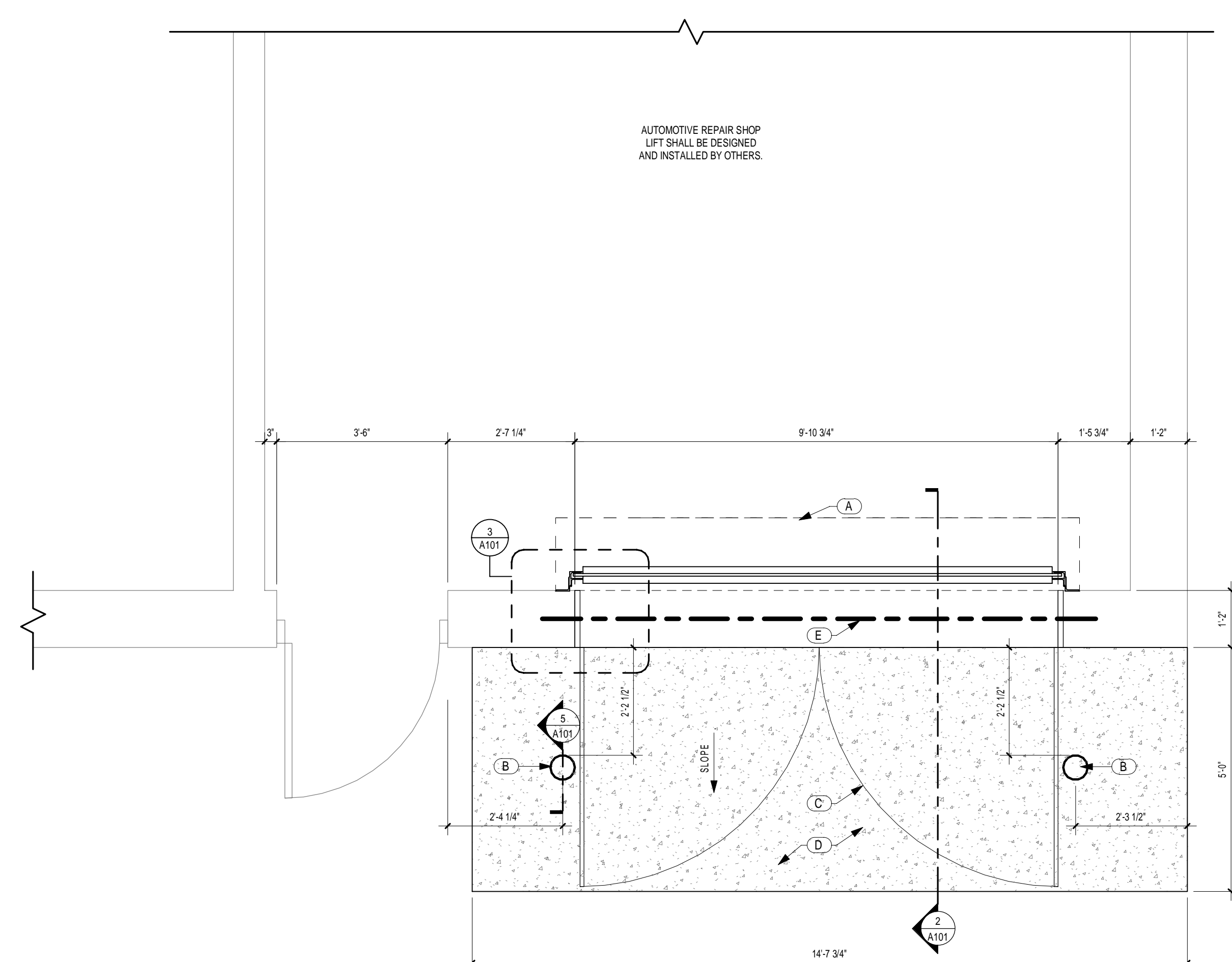

B NEW WORK PLAN
1/2" = 1'-0"

NEW YORK STATE DEPT. OF CORRECTIONS
FRANKLIN CORRECTIONAL FACILITY
62 BARE HILL RD.
TOWN OF MALONE
FRANKLIN COUNTY, STATE OF NEW YORK

PROJECT NO:	2023-162
SCALE:	As indicated
DRAWN BY:	EMW / BMK
CHECKED BY:	BMK
ISSUE DATES:	
DATE	06-21-2024 - BID SET

NEW WORK PLAN & DEMOLITION PLAN

SECURE FACILITY
DON'T SHARE TO PUBLIC

A100

PROGRESS PRINT - NOT FOR CONSTRUCTION

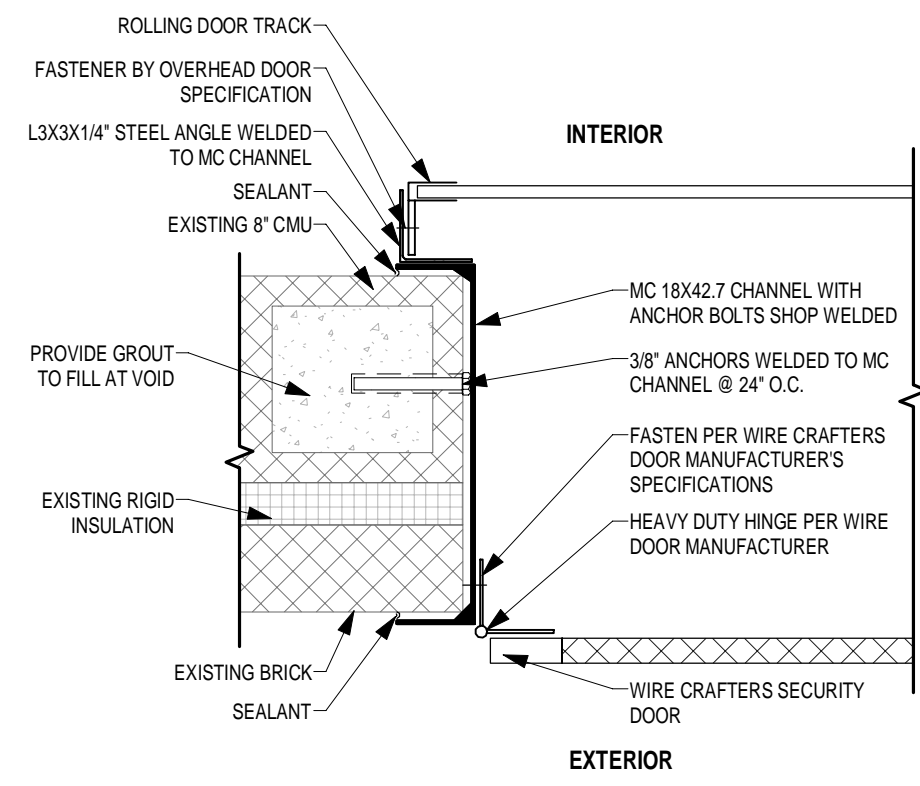

3 SECTION DETAIL
1 1/2" = 1'-0"

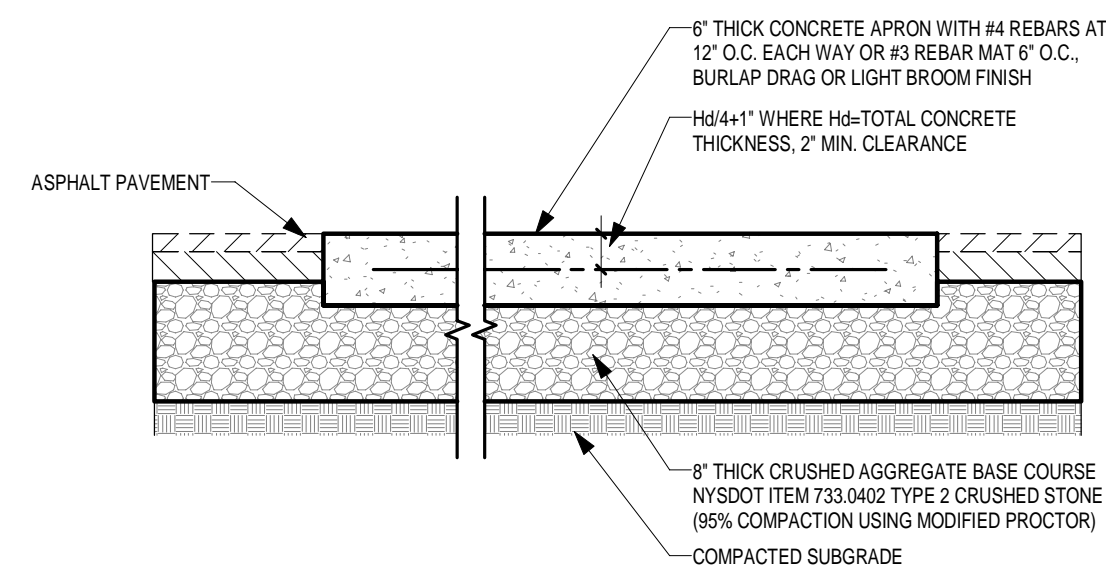

- NOTES:**
1. ALL CONCRETE SHALL BE MINIMUM 4,500 PSI CONCRETE WITH A 550' FLEXURAL STRENGTH
 2. EXPANSION JOINTS TO BE 3/4" WIDE FILLED WITH PREMOLDED JOINT FILLER AND SEALANT CONFORMING TO ASTM D6983.
 3. CONTROL JOINTS SHALL BE SAW CUT WITH A DEPTH OF 1/4 THE CONCRETE THICKNESS.

4 TYPICAL CONCRETE APRON DETAIL
3/4" = 1'-0"

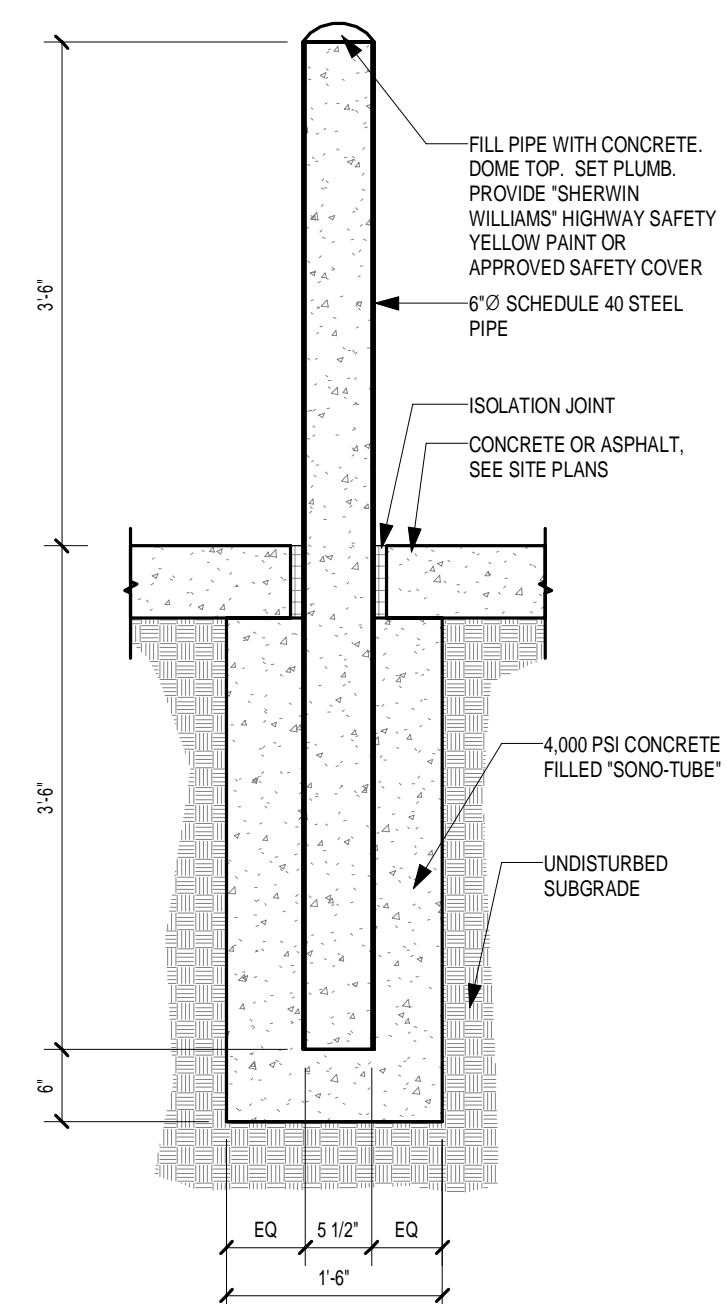

5 TYPICAL BOLLARD DETAIL
3/4" = 1'-0"

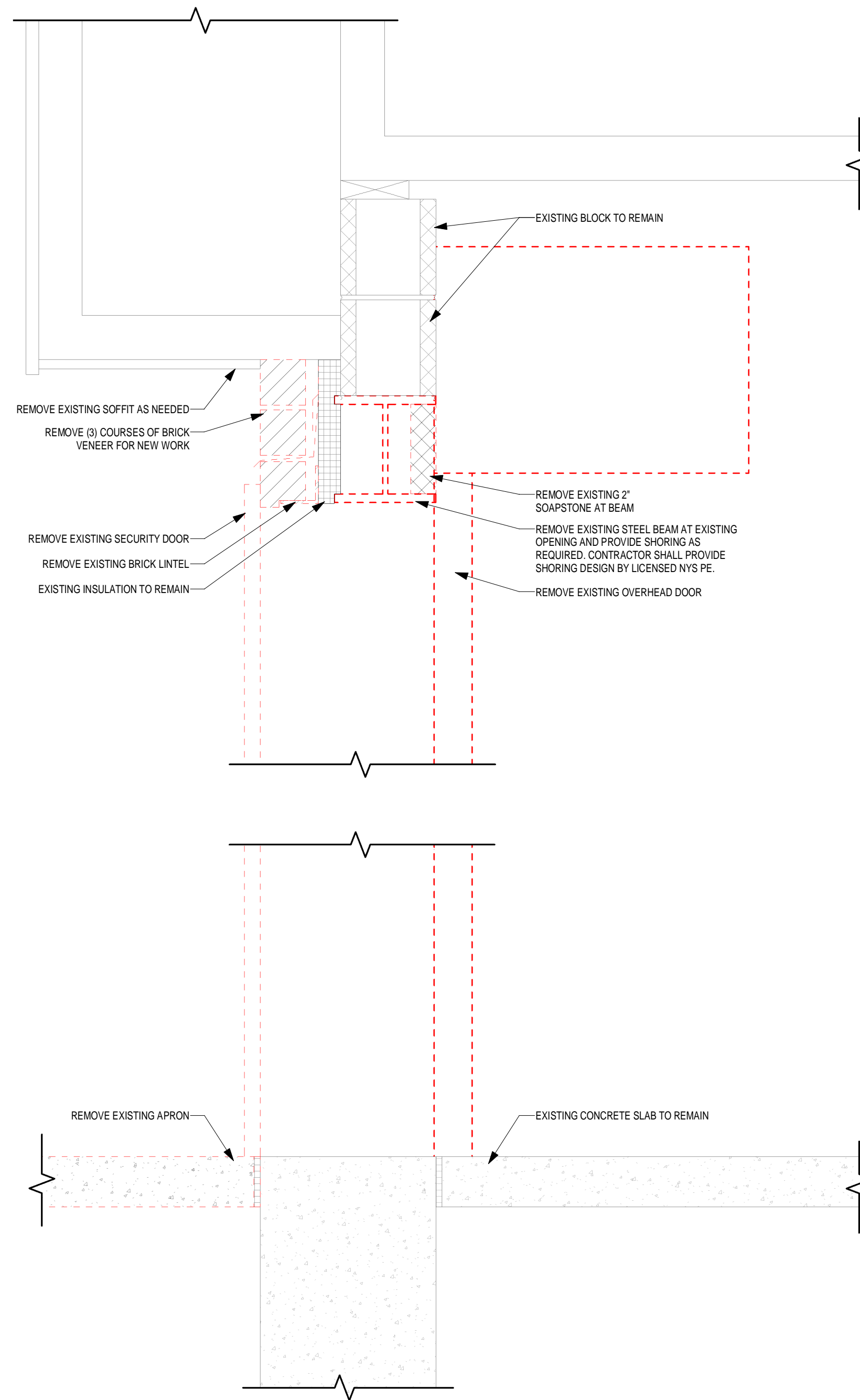

1 DEMOLITION SECTION DETAIL
1 1/2" = 1'-0"

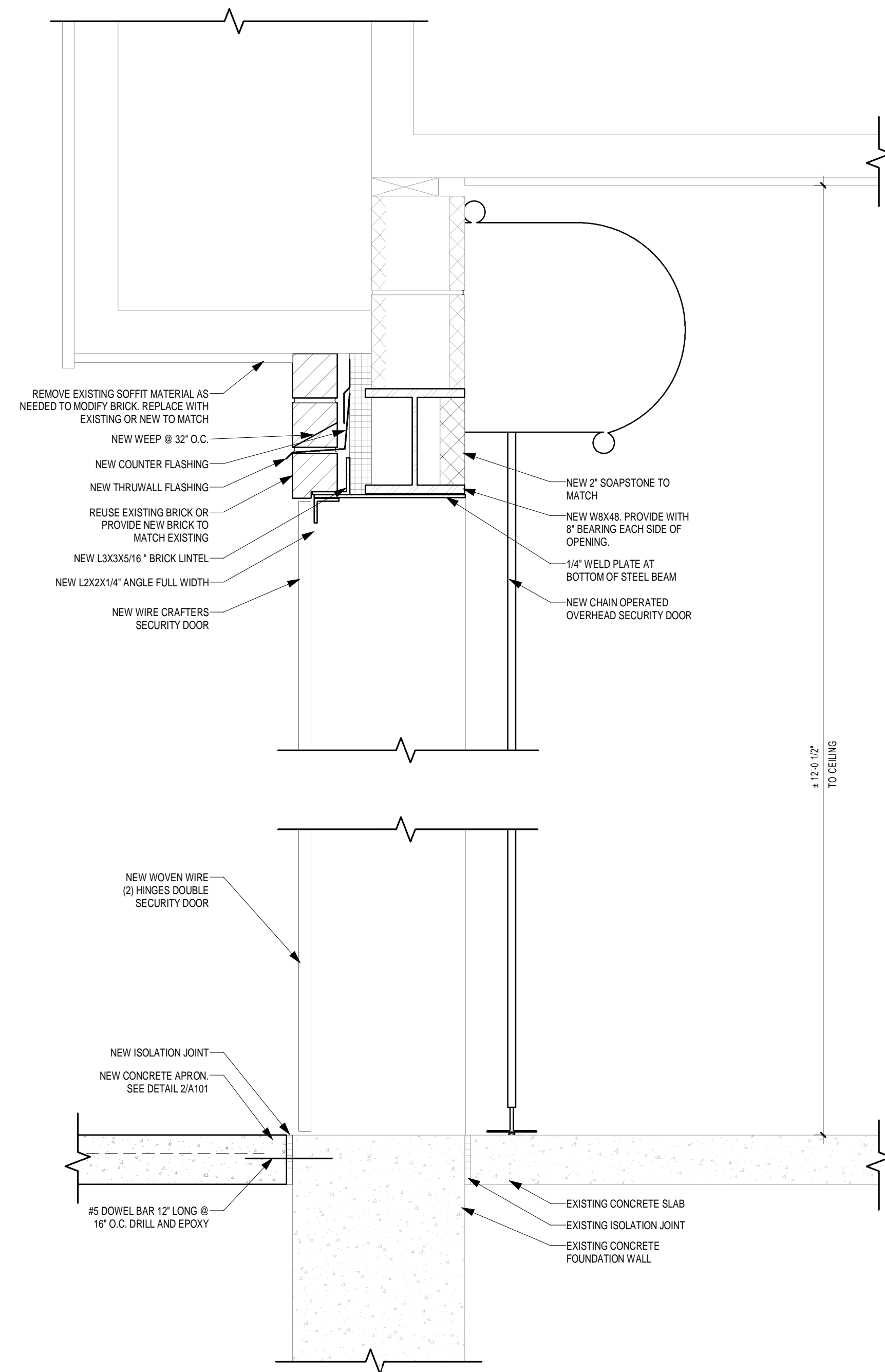

2 NEW WORK SECTION DETAIL
1 1/2" = 1'-0"